

**PRINCIPAL DIMENSIONS**

LENGTH O.A.	14.30 m	46' - 11"
LENGTH W.L.	12.00 m	39' - 5"
BEAM	4.50 m	14' - 9"
DRAFT	2.40 m	7' - 10"
DRAFT	2.20 m	6' - 7"
DRAFT	1.80 m	5' - 11"
DISPLACEMENT STEEL	18.00 t	39680 lbs
DISPLACEMENT ALUMINIUM	14.60 t	32190 lbs
BALLAST(LEAD) STEEL	5.10 t	11240 lbs
BALLAST(LEAD) ALUMINIUM	3.50 t	7710 lbs
FUEL TANK	ca. 700 litre	187 gal
FRESH WATER TANK	ca. 200 litre	52 gal
RECOMM. ENGINE POWER	ca. 70 HP	52 kW

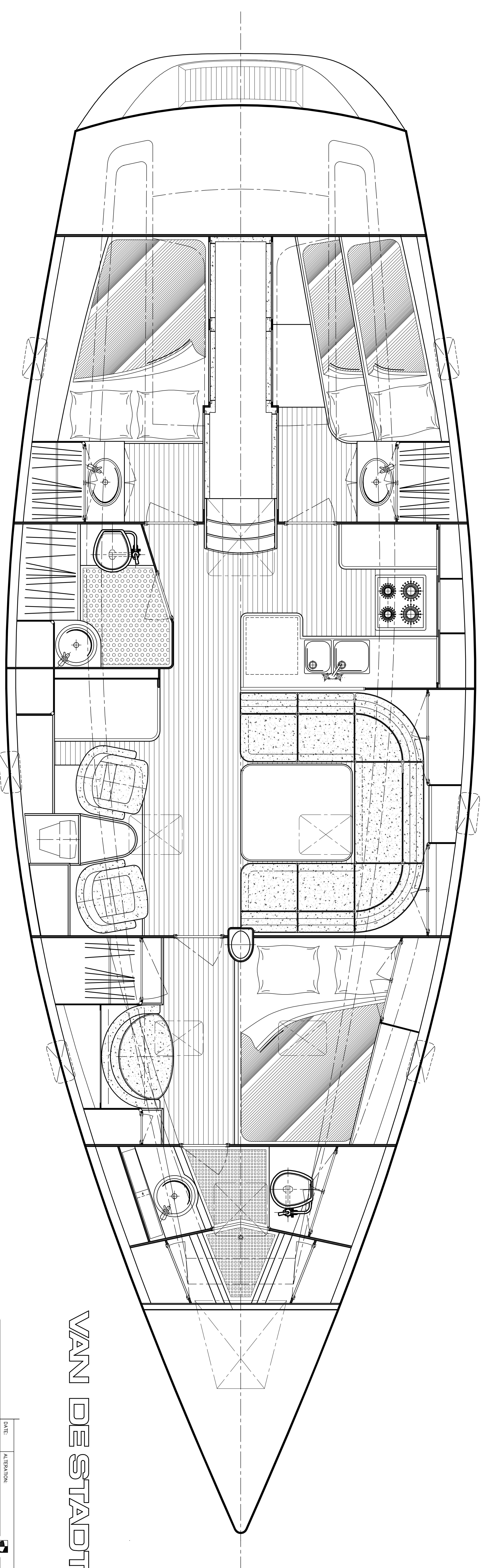

**VAN DE STAAT 47**  
OWNERS VERSION

ALL RIGHTS OF THIS DESIGN AND DETAILS ARE RESERVED.  
 VAN DE STAAT DESIGN  
 E.G. VAN DE STAAT & PARTNERS BV  
 PO BOX 193 1520 AB ROTTERDAM - HOLLAND  
 GENERAL LAY-OUT OWNERS VERSION  
 DATE: 20-9-2007  
 NO.: 426-7-7  
 SAMOA